

Produced by the United States Geological Survey
Control by USGS and NOS/NOAA
Planimetry by photogrammetric methods from aerial photographs taken 1952. Topography by planetable surveys 1952. Revised from aerial photographs taken 1989-90. Field checked 1993. Map edited 1994
Universal Transverse Mercator projection
10,000-foot grid ticks: Louisiana coordinate system, south zone
1000-meter Universal Transverse Mercator grid ticks, zone 16, shown in blue
1927 North American Datum (NAD 27)
North American Datum of 1983 (NAD 83) is shown by dashed corner ticks
The values of the shift between NAD 27 and 83 for 7.5-minute intersections are given in USGS Bulletin 1875
Dashed land lines indicate approximate locations
This map covers an active subsidence area. Evaluate relief and elevation information based on recent sources

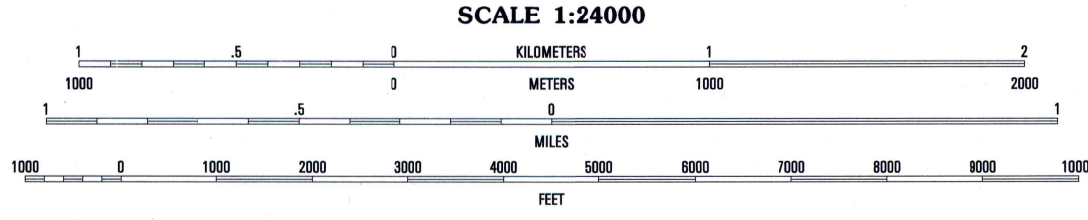

ENTIRE AREA BELOW 5 FEET
NATIONAL GEODETIC VERTICAL DATUM OF 1929

THIS MAP COMPLIES WITH NATIONAL MAP ACCURACY STANDARDS
FOR SALE BY U.S. GEOLOGICAL SURVEY DENVER, COLORADO 80225, OR RESTON, VIRGINIA 22092
AND LOUISIANA DEPARTMENT OF TRANSPORTATION AND DEVELOPMENT, BATON ROUGE, LOUISIANA 70804
A FOLDER DESCRIBING TOPOGRAPHIC MAPS AND SYMBOLS IS AVAILABLE ON REQUEST

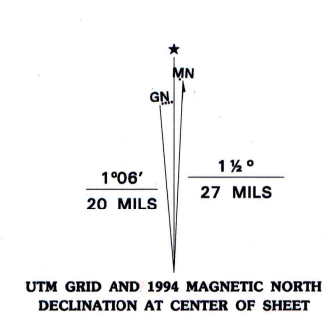

1	2	3	1 Isle Au Pitre
4	5	6	2 Cat Island
7	8	9	3 Three Mile Bay
10	11	12	4 Oak Mound Bayou
13	14	15	5 Mitchell Key

ADJOINING 7.5' QUADRANGLE NAMES

ROAD CLASSIFICATION
No roads or trails in this area

DOOR POINT, LA.
30089-A2-TF-024
1994
DMA 8144 II SW-SERIES V885