

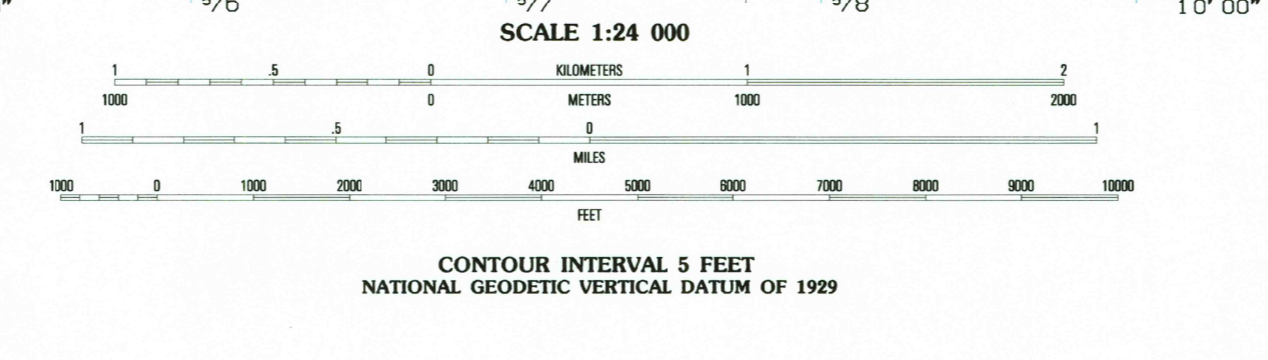

Produced by the United States Geological Survey in cooperation with the State of Louisiana agencies. Compiled by photogrammetric methods from imagery dated 1971. Field checked 1972. Revised from imagery dated 1994. FLS and survey control current as of 1972. Map edited 1996. Contours not revised.

North American Datum of 1983 (NAD 83). Projection and blue 1000-meter ticks: Universal Transverse Mercator, zone 15 10 000-foot ticks: Louisiana Coordinate System of 1983 (north zone) and North American Datum of 1927 (NAD 27) is shown by dashed corner ticks. The values of the shift between NAD 83 and NAD 27 for 7.5-minute intersections are obtainable from National Geodetic Survey NADCON software.

There may be private inholdings within the boundaries of the National or State reservations shown on this map.

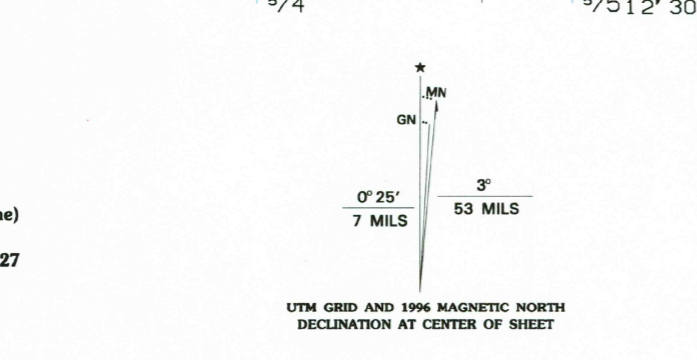

SCALE 1:24 000

CONTOUR INTERVAL 5 FEET
NATIONAL GEODETIC VERTICAL DATUM OF 1929

QUADRANGLE LOCATION

ROAD CLASSIFICATION

Primary highway hard surface	Light-duty road, hard or improved surface
Secondary highway hard surface	Unimproved road
Interstate Route	U.S. Route
	State Route

1	2	3	1 Flatville
4	5	6	2 Nebo
7	8	7	3 Bird Island Point
		8	4 Green Gables
			5 Buckeye NE
			6 Liboue
			7 Buckeye
			8 Powell Point

ADJOINING 7.5' QUADRANGLE NAMES

THIS MAP COMPLIES WITH NATIONAL MAP ACCURACY STANDARDS
FOR SALE BY U.S. GEOLOGICAL SURVEY, DENVER, COLORADO 80225, OR RESTON, VIRGINIA 22092
AND LOUISIANA DEPARTMENT OF TRANSPORTATION AND DEVELOPMENT, BATON ROUGE, LOUISIANA 70804
A FOLDER DESCRIBING TOPOGRAPHIC MAPS AND SYMBOLS IS AVAILABLE ON REQUEST

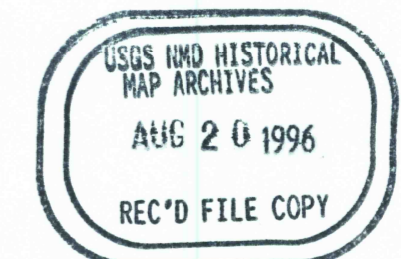

HOLLOWAY, LA
31092-D2-TF-024
1994
DMA 7546 1 NW-SERIES V885

