

Mapped, edited, and published by the Geological Survey Control by USGS, NOS/NOAA, and Louisiana Department of Highways Planimetry by photogrammetric methods from aerial photographs taken 1978 and 1980. Topography by planetable surveys 1954-55 Revised from aerial photographs taken 1978 and 1980. Field checked 1982 Map edited 1983 Projection and 10,000-foot grid ticks: Louisiana coordinate system, south zone (Lambert conformal conic) 1000-meter Universal Transverse Mercator grid, zone 15 1927 North American Datum To place on the predicted North American Datum 1983 move the projection lines 18 meters south and 13 meters east as shown by dashed corner ticks Red tint indicates areas in which only landmark buildings are shown All or part of this quadrangle lies within a subsidence area

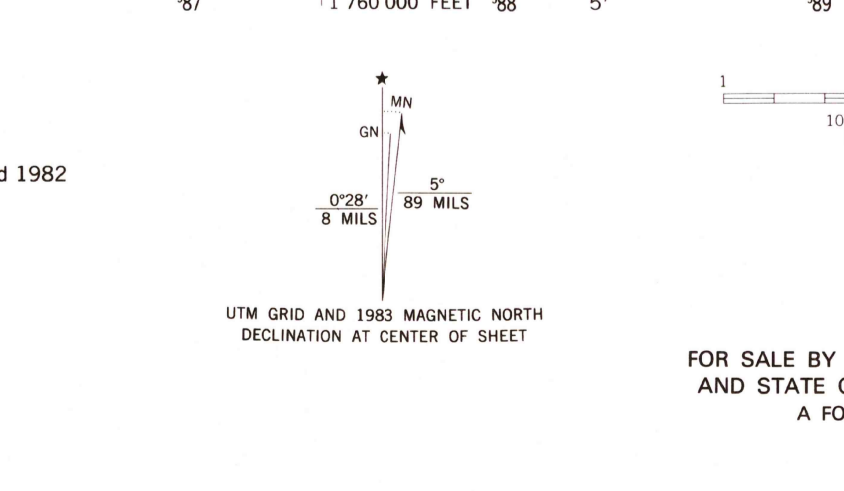

THIS MAP COMPLIES WITH NATIONAL MAP ACCURACY STANDARDS FOR SALE BY U. S. GEOLOGICAL SURVEY, DENVER, COLORADO 80225, OR RESTON, VIRGINIA 22092 AND STATE OF LOUISIANA, DEPARTMENT OF PUBLIC WORKS, BATON ROUGE, LOUISIANA 70804 A FOLDER DESCRIBING TOPOGRAPHIC MAPS AND SYMBOLS IS AVAILABLE ON REQUEST

ROAD CLASSIFICATION: Primary highway, hard surface; Secondary highway, hard surface; Interstate Route; U. S. Route; State Route; Light-duty road, hard or improved surface; Unimproved road. Includes a locator map of Louisiana and a stamp: 'NOV 23 1982'.

LAFAYETTE, LA. NE4 LAFAYETTE 15' QUADRANGLE N3007.5-W9200.75 1983 DMA 7544 II NE-SERIES V885