

Mapped, edited, and published by the Geological Survey
Control by USGS and USC&GS
Planimetry by photogrammetric methods from aerial photographs taken 1963. Topography by planetable surveys 1964
Polyconic projection. 1927 North American datum
10,000-foot grid based on Louisiana coordinate system, south zone
1000-meter Universal Transverse Mercator grid ticks, zone 15, shown in blue
To place on the predicted North American Datum 1983
move the projection lines 20 meters south and
8 meters east as shown by dashed corner ticks
All or part of this quadrangle lies within a subsidence area
Where omitted, land lines have not been established
Fine red dashed lines indicate selected fence and field lines where
generally visible on aerial photographs. This information is unchecked

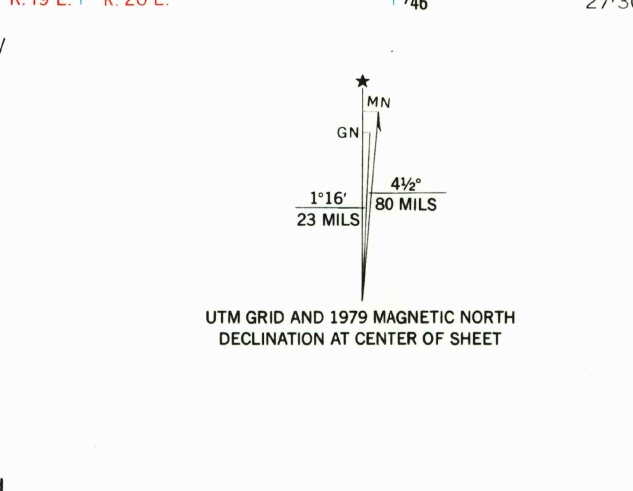

SCALE 1:24 000
1 MILE
7000 FEET
1 KILOMETER
CONTOUR INTERVAL 5 FEET
NATIONAL GEODETIC VERTICAL DATUM OF 1929

ROAD CLASSIFICATION
Medium-duty
Light-duty

USGS NMD HISTORICAL MAP
APR 18 1986
REC'D FILE COPY

LAKE BULLY CAMP, LA.
NW/4 LAKE FELICITY 15' QUADRANGLE
29090-D4-TF-024
1964
PHOTOREVISED 1979
DMA 7942 IV NW--SERIES V885

THIS MAP COMPLIES WITH NATIONAL MAP ACCURACY STANDARDS
FOR SALE BY U. S. GEOLOGICAL SURVEY, DENVER, COLORADO 80225, OR RESTON, VIRGINIA 22092
AND BY THE STATE OF LOUISIANA, DEPARTMENT OF PUBLIC WORKS, BATON ROUGE, LOUISIANA 70804
A FOLDER DESCRIBING TOPOGRAPHIC MAPS AND SYMBOLS IS AVAILABLE ON REQUEST

Revisions shown in purple and woodlands from aerial photographs taken 1976. Map edited 1979. This information not field checked