

Mapped, edited, and published by the Geological Survey
Control by USGS and USC&GS
Orthophotomap prepared from high-altitude aerial photographs
taken October 24, 1971. Topography by planetable surveys 1971
Supersedes planimetric map dated 1935
Selected hydrographic data compiled from USC&GS Chart 1272 (1969)
This information is not intended for navigational purposes
Polyconic projection. 1927 North American datum
10,000-foot grid based on Louisiana coordinate system,
south zone
1000-meter Universal Transverse Mercator grid ticks,
zone 16, shown in blue
All or part of this quadrangle lies within a subsidence area
Where omitted, land lines have not been established or
are not shown because of insufficient data

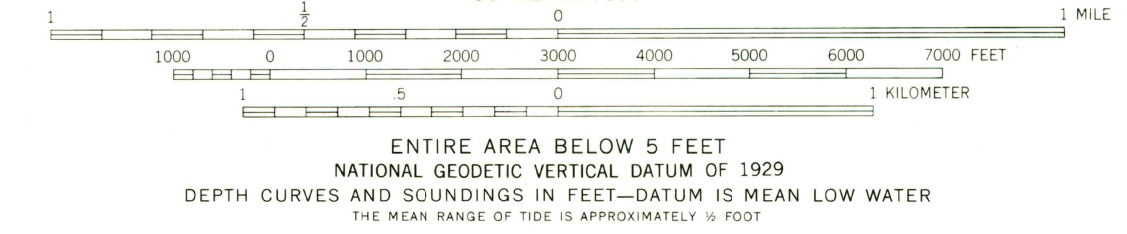

THIS MAP COMPLIES WITH NATIONAL MAP ACCURACY STANDARDS
FOR SALE BY U. S. GEOLOGICAL SURVEY, DENVER, COLORADO 80225, OR RESTON, VIRGINIA 22092
AND LOUISIANA DEPARTMENT OF PUBLIC WORKS, BATON ROUGE, LOUISIANA 70804
A FOLDER DESCRIBING TOPOGRAPHIC MAPS AND SYMBOLS IS AVAILABLE ON REQUEST

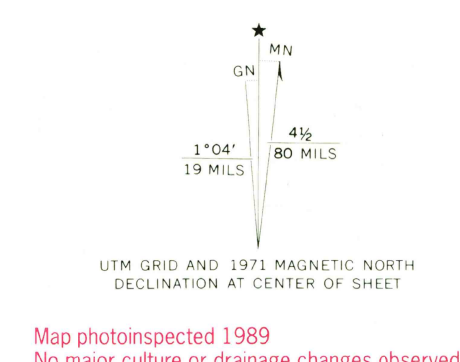

The difference between 1927 North American Datum and North American Datum of 1983 (NAD 83) for 7.5-minute intersections is given in USGS Bulletin 1875. The NAD 83 is shown by dashed corner ticks

ROAD CLASSIFICATION
No roads or trails in this area

PASS A LOUTRE WEST, LA.
NW/4 EAST DELTA 15' QUADRANGLE
29089-82-1F-024
1971
PHOTOINSECTED 1989
DMA 8142 II NW—SERIES V8850