

Produced by the United States Geological Survey
in cooperation with State of Louisiana agencies
Planimetry by photogrammetric methods from imagery dated 1951
Topography by planimetric surveys 1954-55. Revised from imagery
dated 1994. PLUS and survey control current as of 1994-55
Map edited 1996. Contours not revised. Contours that conflict with
revised planimetry are dashed.
Selected hydrographic data compiled from NOS Chart 592
This information is not intended for navigational purposes
North American Datum of 1983 (NAD 83). Projection and
blue 1000-meter ticks: Universal Transverse Mercator, zone 15
10 000-foot ticks: Louisiana Coordinate System of 1983 (south zone)
North American Datum of 1927 (NAD 27) is shown by dashed
corner ticks. The values of the shift between NAD 83 and NAD 27
for 7.5-minute intersections are obtainable from National Geodetic
Survey NADCON software
This map covers a subsidence area. Evaluate relief and
elevation information based on recent sources
There may be private inholdings within the boundaries of
the National or State reservations shown on this map

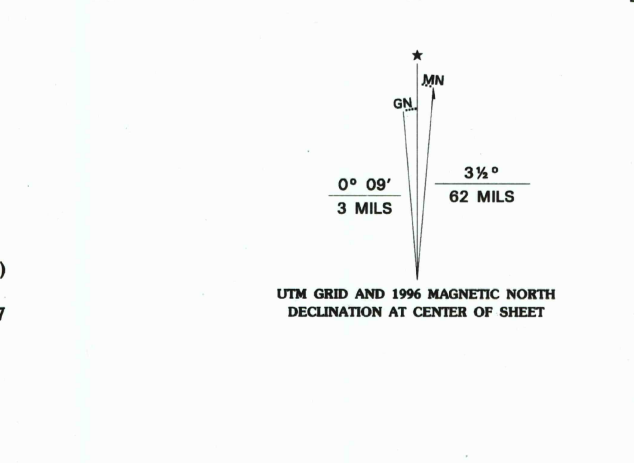

SCALE 1:24 000
KILOMETERS
METERS
MILES
FEET
CONTOUR INTERVAL 5 FEET
NATIONAL GEODETIC VERTICAL DATUM OF 1929
DEPTH CURVES AND SOUNDINGS IN FEET, DATUM IS MEAN LOWER LOW WATER
THE RELATIONSHIP BETWEEN THE TWO DATUMS IS VARIABLE
SHORELINE SHOWN REPRESENTS THE APPROXIMATE LINE OF MEAN HIGH WATER
FOR SALE BY U.S. GEOLOGICAL SURVEY, DENVER, COLORADO 80225, OR RESTON, VIRGINIA 22092
AND LOUISIANA DEPARTMENT OF TRANSPORTATION AND DEVELOPMENT, BATON ROUGE, LOUISIANA 70804
A FOLDER DESCRIBING TOPOGRAPHIC MAPS AND SYMBOLS IS AVAILABLE ON REQUEST

ROAD CLASSIFICATION

- Primary highway hard surface
- Secondary highway hard surface
- Light-duty road, hard or improved surface
- Unimproved road

QUADRANGLE LOCATION

1	2	3
4	5	6
7	8	

1 Bristol
2 Buhler
3 Moss Bluff
4 Sulphur
5 Lake Charles
6 Black Lake
7 Moss Lake
8 Lake Charles SW

WESTLAKE, LA
30093-B3-TF-024
1994
DMA 7344 III NE-SERIES V885

REC'D FILE COPY
NOV 26 1996
USGS HISTORICAL MAP ARCHIVES

ADJOINING 7.5' QUADRANGLE NAMES