



U.S. DEPARTMENT OF THE INTERIOR
U.S. GEOLOGICAL SURVEY



STATE OF LOUISIANA
DEPARTMENT OF TRANSPORTATION AND DEVELOPMENT

BAY DOSGRIS QUADRANGLE
LOUISIANA
7.5-MINUTE SERIES (TOPOGRAPHIC)

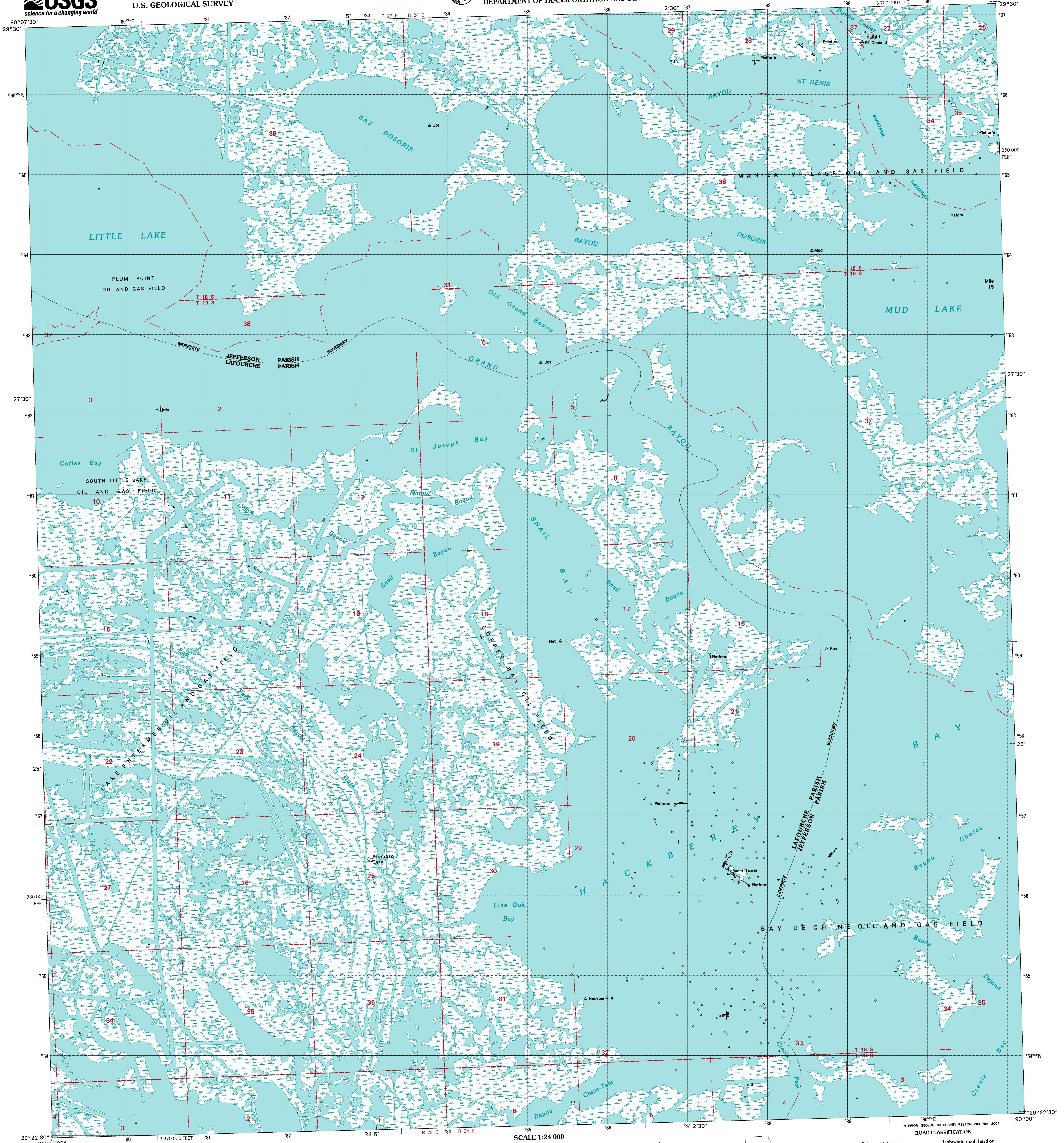

Produced by the United States Geological Survey in cooperation with Louisiana Department of Transportation and Development
Topography compiled 1989. Planimetry derived from imagery taken 1978 and other sources. Public Land Survey System and survey control current as of 1992. Boundaries current as of 2001
North American Datum of 1983 (NAD 83). Projection and datum of 1983. Universal Transverse Mercator, zone 15
1 000-meter grid; Louisiana Coordinate System of 1983 (south zone)
North American Datum of 1927 (NAD 27) is shown by dashed corner ticks. The values of the shift between NAD 83 and NAD 27 for 7.5-minute intersections are obtainable from National Geodetic Survey NADCON software
This quadrangle covers a subsidence area
Houses of worship, schools, and other labeled buildings verified 1992
Where omitted, land lines have not been established

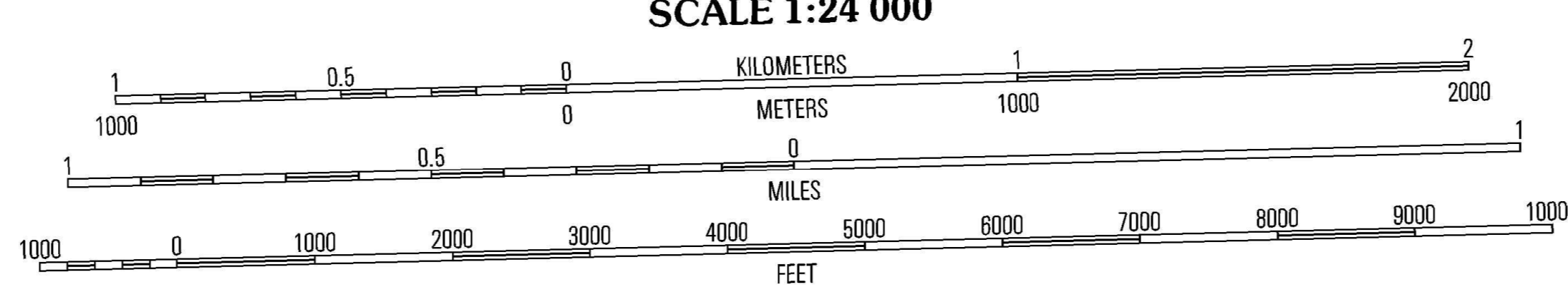
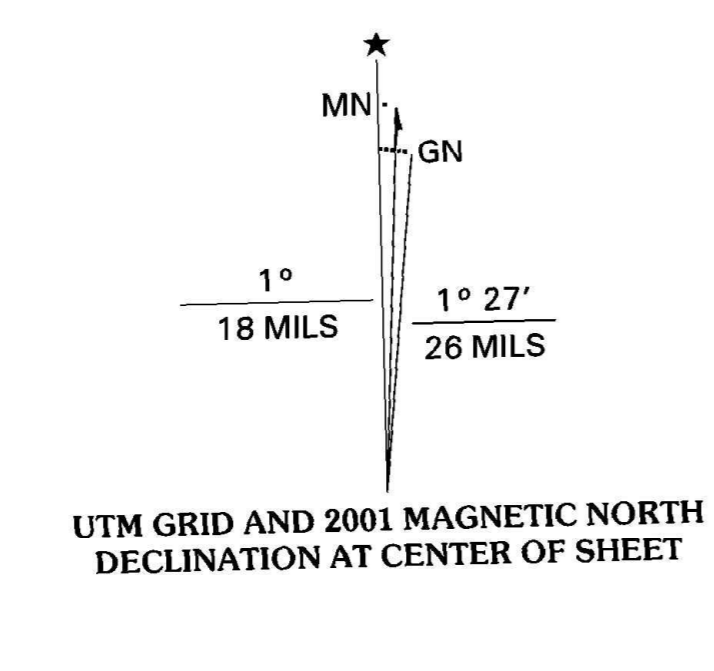

CONTOUR INTERVAL 5 FEET
NATIONAL GEODETIC VERTICAL DATUM OF 1929
TO CONVERT FROM FEET TO METERS, MULTIPLY BY 0.3048



QUADRANGLE LOCATION

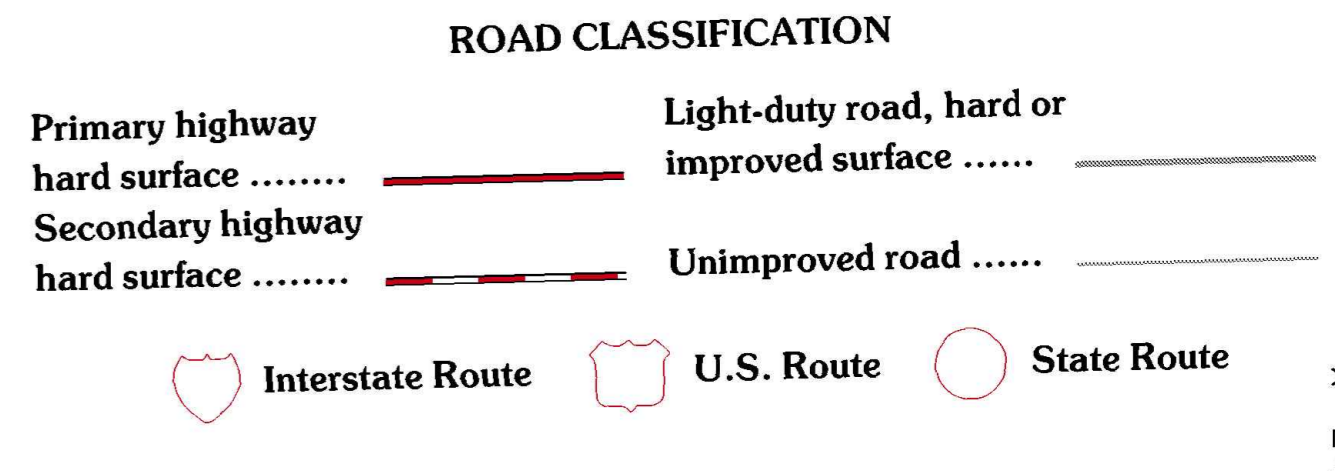

1	2	3	1 Bay L'Ours
4	5	6	2 The Bayou Bay
7	8	7	3 Lake Laurier
		8	4 Golden Meadow Farms
			5 Wilmon Bay
			6 Miah Bayou
			7 Bay Tanhouer
			8 Barataria Pass

BAY DOSGRIS, LA
1998
NIMA 7942 I NE-SERIES V885

THIS MAP COMPLIES WITH NATIONAL MAP ACCURACY STANDARDS
FOR SALE BY U.S. GEOLOGICAL SURVEY, P.O. BOX 25286, DENVER, COLORADO 80225
AND LOUISIANA DEPARTMENT OF TRANSPORTATION AND DEVELOPMENT, BATON ROUGE, LOUISIANA 70804
A FOLDER DESCRIBING TOPOGRAPHIC MAPS AND SYMBOLS IS AVAILABLE ON REQUEST

