

Produced by the United States Geological Survey Topography compiled 1967. Planimetry derived from imagery taken 1998 and other sources. Public Land Survey System and survey control current as of 1967. North American Datum of 1983 (NAD 83). Projection and 1 000-meter grid: Universal Transverse Mercator, zone 16 10 000-foot ticks: Louisiana Coordinate System of 1983 (south zone) North American Datum of 1927 (NAD 27) is shown by dashed corner ticks. The values of the shift between NAD 83 and NAD 27 for 7.5-minute intersections are obtainable from National Geodetic Survey NADCON software. There may be private inholdings within the boundaries of the National or State reservations shown on this map. Where omitted, land lines have not been established. City of New Orleans and Orleans Parish are coextensive. This quadrangle covers a subsidence area. Landmark buildings verified 1967.

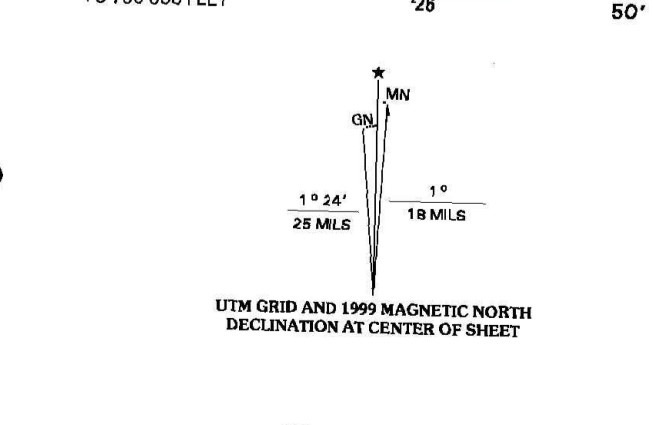

SCALE 1:24 000  
CONTOUR INTERVAL 5 FEET  
NATIONAL GEODETIC VERTICAL DATUM OF 1929  
TO CONVERT FROM FEET TO METERS, MULTIPLY BY 0.3048

ROAD CLASSIFICATION  
Primary highway hard surface  
Secondary highway hard surface  
Unimproved road  
Light-duty road, hard or improved surface  
Interstate Route  
U.S. Route  
State Route

QUADRANGLE LOCATION (Map of Louisiana showing the quadrangle's position)

1	2	3	1 South Point
4	5	6	2 North Shore
7	8	9	3 Ripoles
			4 Little Woods
			5 Alligator Point
			6 Chalmette
			7 Maréchal Point
			8 Proctor Point

ADJOINING 7.5' QUADRANGLE NAMES

THIS MAP COMPLIES WITH NATIONAL MAP ACCURACY STANDARDS FOR SALE BY U.S. GEOLOGICAL SURVEY, P.O. BOX 25286, DENVER, COLORADO 80225 AND LOUISIANA DEPARTMENT OF TRANSPORTATION AND DEVELOPMENT, BATON ROUGE, LOUISIANA 70804 A FOLDER DESCRIBING TOPOGRAPHIC MAPS AND SYMBOLS IS AVAILABLE ON REQUEST

CHEF MENTEUR, LA 1998 NIMA 8044 III SE-SERIES V885

