

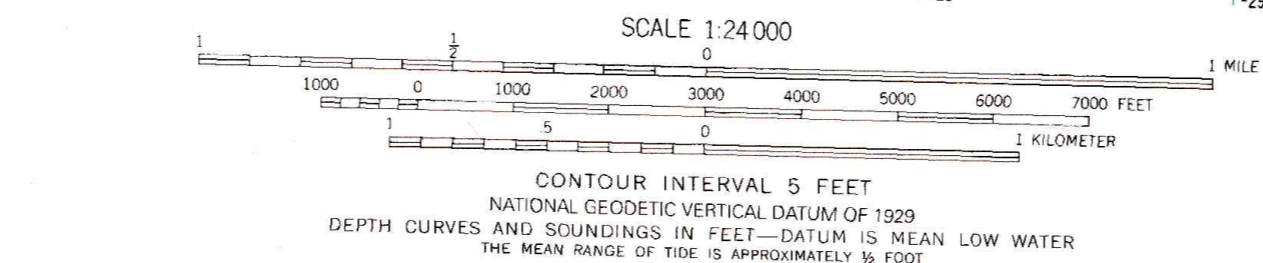

Produced by the United States Geological Survey  
Control by USGS and NOS/NOAA  
Orthophotomaps prepared from high-altitude aerial photographs taken Oct. 24, 1971. Topography by planetable surveys 1973  
Selected hydrographic data compiled from USC&GS Chart 1271(1972)  
This information is not intended for navigational purposes  
Projection and 10,000-foot grid ticks: Louisiana coordinate system, south zone (Lambert conformal conic)  
1000-meter Universal Transverse Mercator grid ticks, zone 16, shown in blue. 1927 North American datum  
The difference between 1927 North American Datum and North American Datum of 1983 (NAD 83) for 7.5-minute intersections is given in USGS Bulletin 1875. The NAD 83 is shown by dashed corner ticks  
All or part of this quadrangle lies within a subsidence area  
Where omitted, land lines have not been established or are not shown because of insufficient data

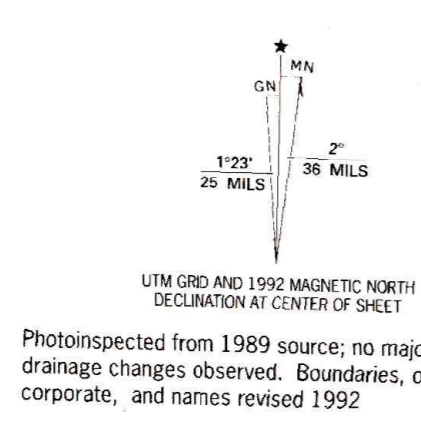

THIS MAP COMPLIES WITH NATIONAL MAP ACCURACY STANDARDS  
FOR SALE BY U.S. GEOLOGICAL SURVEY, DENVER, COLORADO 80225, OR RESTON, VIRGINIA 22092  
AND LOUISIANA DEPARTMENT OF TRANSPORTATION AND DEVELOPMENT, BATON ROUGE, LOUISIANA 70804  
A FOLDER DESCRIBING TOPOGRAPHIC MAPS AND SYMBOLS IS AVAILABLE ON REQUEST

QUADRANGLE LOCATION

|   |   |   |                       |
|---|---|---|-----------------------|
| 1 | 2 | 3 | 1 Phoenix             |
| 2 | 3 | 4 | 2 Lake Batola         |
| 3 | 4 | 5 | 3 Lake Cuetro Caballo |
| 4 | 5 | 6 | 4 Lake Laurier        |
| 5 | 6 | 7 | 5 Happy Jack          |
| 6 | 7 | 8 | 6 Wilkinson Bay       |
|   |   |   | 7 Bay Saline          |
|   |   |   | 8 Port Sulphur        |

ADJOINING 7.5' QUADRANGLE NAMES

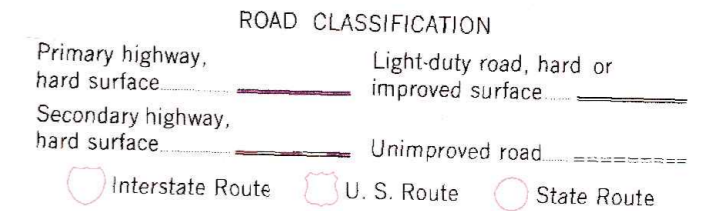

POINTE A LA HACHE, LA.  
SE 1/4 POINTE A LA HACHE 15' QUADRANGLE  
29089-E7-0M-024  
1973  
MINOR REVISION 1992  
DMA 8043 III SE-SERIES V8850