



U.S. DEPARTMENT OF THE INTERIOR
U.S. GEOLOGICAL SURVEY



STATE OF LOUISIANA
DEPARTMENT OF TRANSPORTATION AND DEVELOPMENT

SOUTH PASS QUADRANGLE
LOUISIANA-PLAQUEMINES PARISH
7.5-MINUTE SERIES (TOPOGRAPHIC)

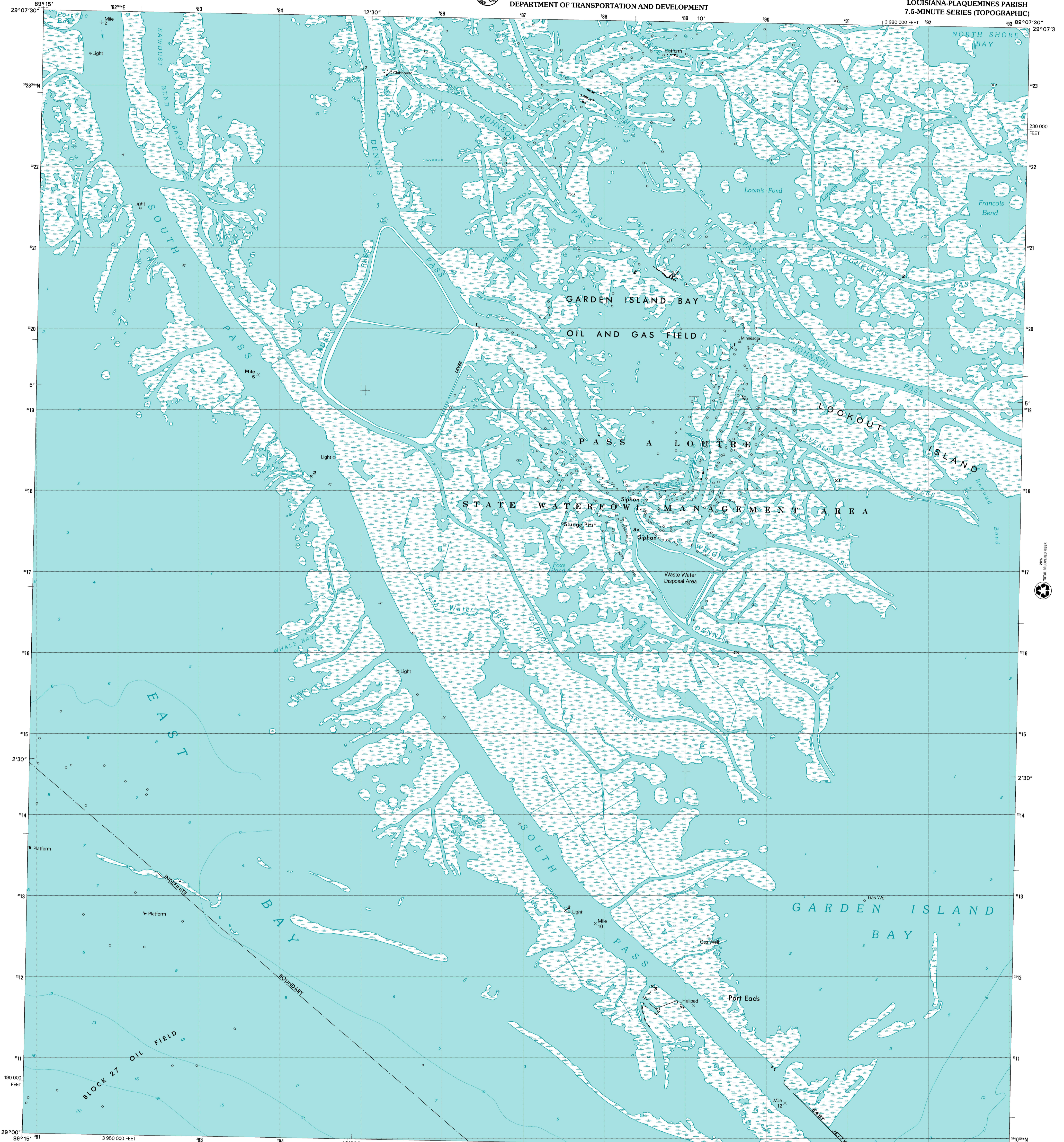

Produced by the United States Geological Survey
Topography compiled 1971. Planimetry derived from imagery taken 1996 and other sources, Public Land Survey System and survey control current as of 1971. Boundaries current as of 2002.
Selected hydrographic data compiled from USCGS Chart 1272 (1969). This information is not intended for navigational purposes.
North American Datum of 1983 (NAD 83). Projection and 10 000-foot ticks: Universal Transverse Mercator, zone 16R (south zone).
North American Datum of 1927 (NAD 27) is shown by dashed corner ticks. The values of the shift between NAD 27 for 7.5-minute intersections are obtainable from National Geographic Survey NADCON software.
There may be private holdings within the boundaries of the National or State reservations shown on this map.
Houses of worship, schools, and other labeled buildings verified 1971.
This quadrangle covers a subsidence area.

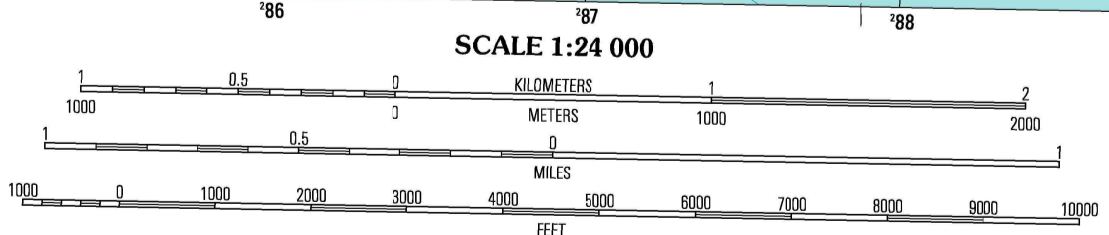
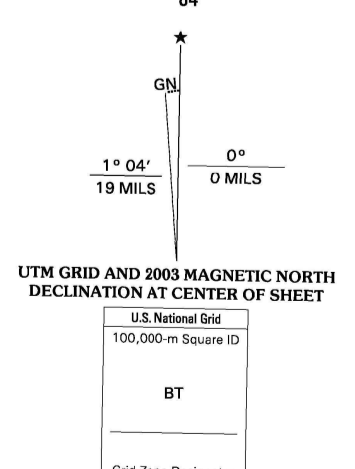

SCALE 1:24 000
ALL ELEVATIONS BETWEEN ZERO AND 5 FEET ABOVE DATUM
NATIONAL GEODETIC VERTICAL DATUM OF 1929
DEPTH CURVES AND SOUNDINGS IN FEET-DATUM IS MEAN LOWER LOW WATER
THE RELATIONSHIP BETWEEN THE TWO DATUMS IS VARIABLE
THE MEAN RANGE OF TIDE IS APPROXIMATELY 3 FEET
TO CONVERT FROM FEET TO METERS, MULTIPLY BY 0.3048
THIS MAP COMPLIES WITH NATIONAL MAP ACCURACY STANDARDS
FOR SALE BY U.S. GEOLOGICAL SURVEY, P. O. BOX 25286, DENVER, COLORADO 80225
AND LOUISIANA DEPARTMENT OF TRANSPORTATION AND DEVELOPMENT, BATON ROUGE, LOUISIANA 70804
A FOLDER DESCRIBING TOPOGRAPHIC MAPS AND SYMBOLS IS AVAILABLE ON REQUEST



ROAD CLASSIFICATION
Primary highway
hard surface
Secondary highway
hard surface
Unimproved road
Light-duty road, hard or
improved surface
Interstate Route
U.S. Route
State Route

1	2	3	1 Pilotown
4	5	6	2 Pass A Loure West
7	8	9	3 Pass A Loure East
			4 Dixon Bay
			5 Garden Island Pass
			6 Berwick Bay East
			7 South Of South Pass
			8

SOUTH PASS, LA
1998
NIMA 8142 II SW-SERIES V885

